

Diâmetro mínimo sem ferramenta

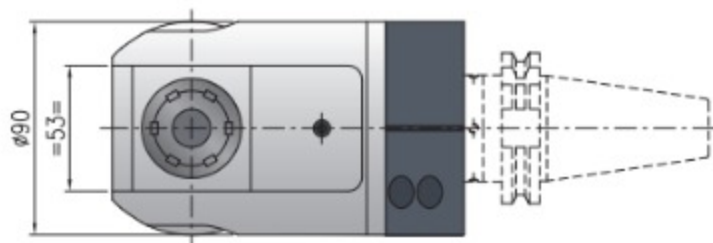

Relação
1:1

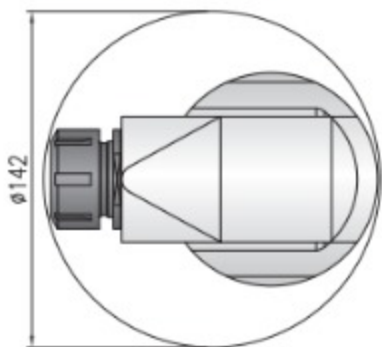

RPM
4.000 min⁻¹



Carga axial max.
480 N



Torque
18 Nm



Peso
7 kg



Pinça
ER-25 ϕ 1/16 mm

*** ACESSÓRIOS INCLUSOS:**

- Caixa especial
- Chaves
- Tubo de graxa
- Instruções de uso

 Sentido da rotação oposto do fuso da máquina

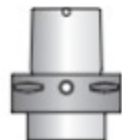
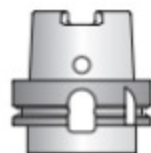

| Mandril | DIN-69871 | | CAT | | MAS-BT | | HSK | | CAPTO | | KM | | |
|----------|----------------|-----|-----------|------|--------------|------|-------|-----|--------------|-----------|--------------|-----------|--------------|
| Tamanho | 40 | 50 | 40 | 50 * | 40 | 50 * | 63-80 | 100 | C5-C6 | C8 | 50-63 | | |
| I | 65-80 - (110*) | | 80-(110*) | | 65-80-(110*) | | 80 | | 65-80-(110*) | 80-(110*) | 65-80-(110*) | 80-(110*) | 65-80-(110*) |
| S | 35 | 35 | 35 | 41 | 42 | 45 | 38 | 40 | 40 | | | | |
| L | 150 | 150 | 150 | 156 | 157 | 160 | 153 | 155 | 155 | | | | |

*opcional

* Pronta entrega, demais mandris sob consulta.

Opções sob encomenda:



bar max
12

Refrigeração através
do pino



min⁻¹
6.000

High speed opcional RPM max.



Ø mm max.
16

Weldon